

SECTION A'A

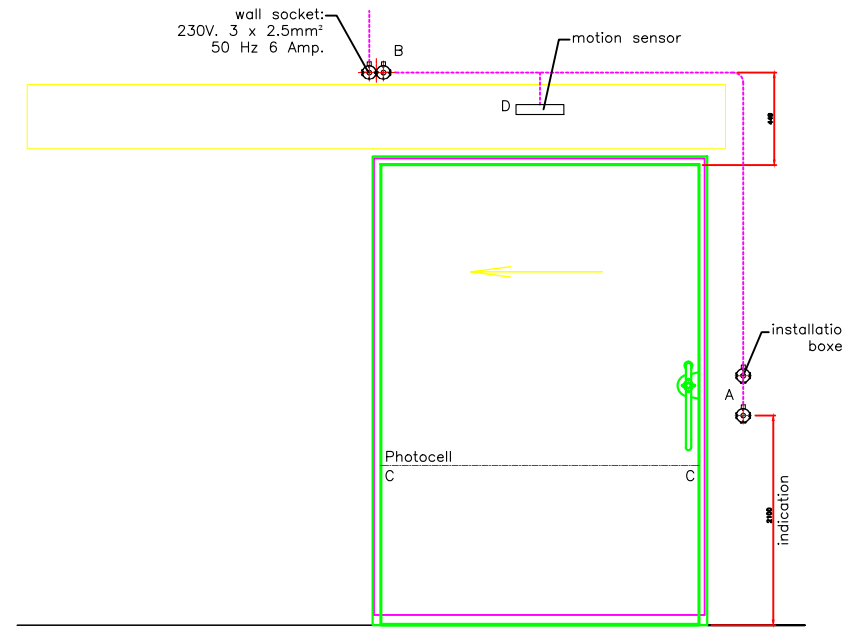

* = Supplied by third party
Mounting surface must be flat and level
Wall thickness max. 150mm

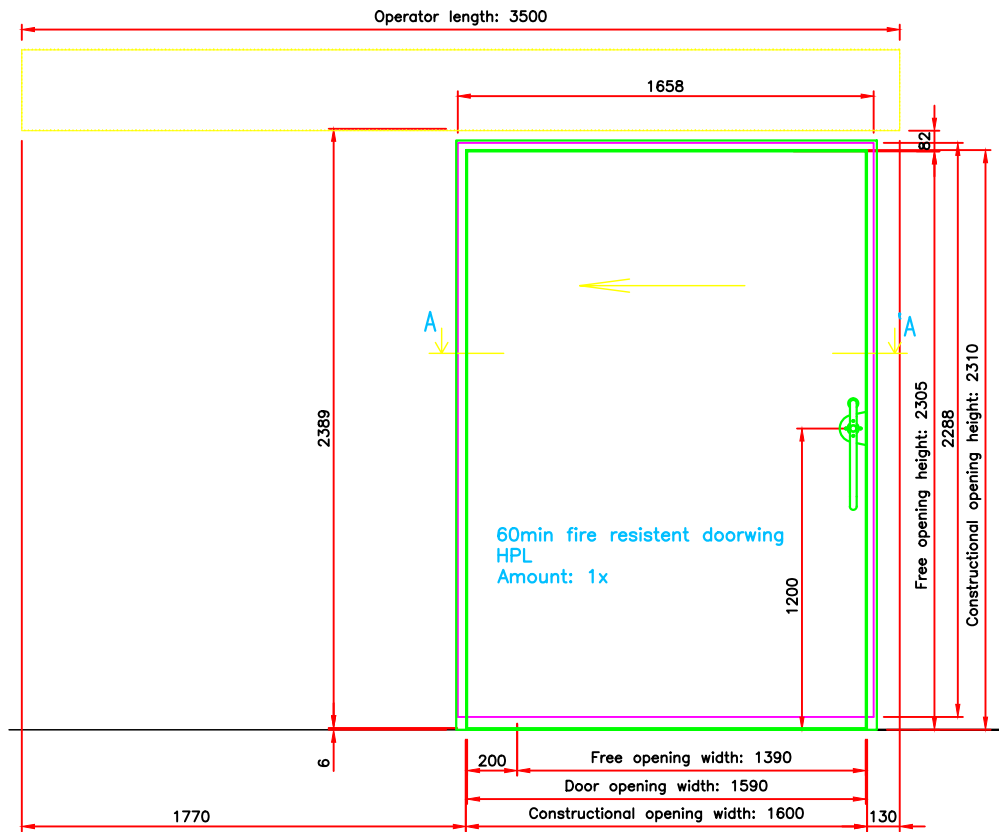
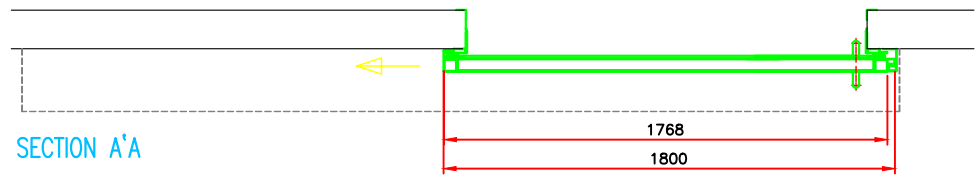
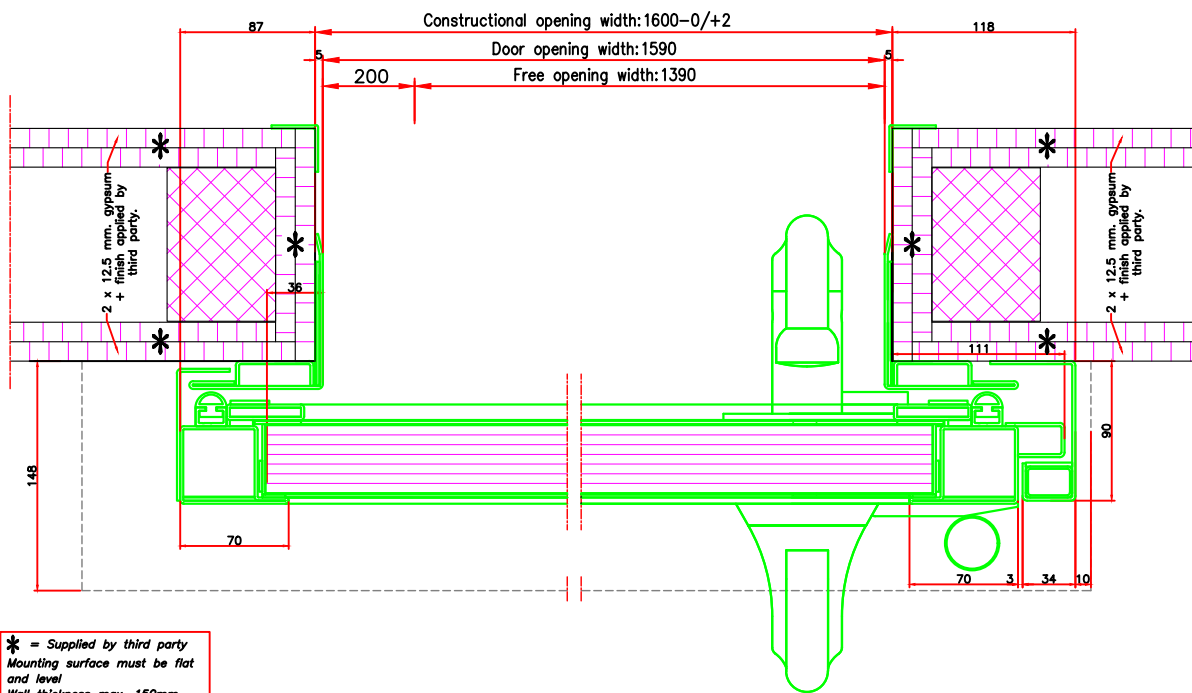
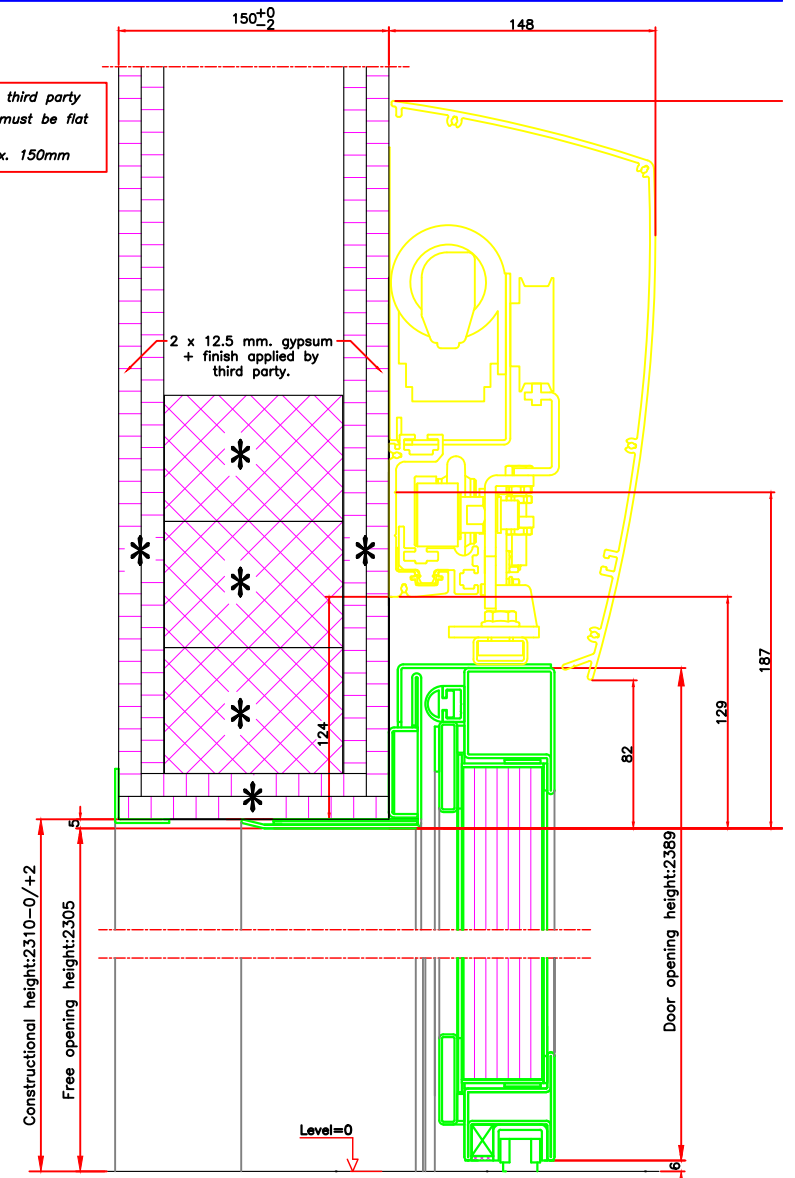

* = Supplied by third party
Mounting surface must be flat and level
Wall thickness max. 150mm

implementable signaling devices		
position	device	symbol
A	push button, 4 x 0.34mm ²	
A	domed push button, 4 x 0.34mm ²	
A	push button 2-positions, 4 x 0.34mm ²	
A	key switch, 4 x 0.34mm ²	
A	pull switch, 4 x 0.34mm ²	
A	elbow push switch, 4 x 0.34mm ²	
A	PGS wired UTP Cat5, 8 wires Ø0,5mm	
B	wall socket: 230V, 3 x 2.5mm ²	
C	photocell incl. cable	
D	motion sensor incl. cable	

other implementable electrical devices	
INPUT:	- intercom
	- fire alarm system
potential free contact switch	
OUTPUT:	- bel switch
	- alarm system
I _{max} = 400mA	

Title: KONE HS60 fire resistance 60 min		Drawing number:
Order number:	Page no.:	Projection ISO-128
Date:	Scale: --	Revision number:
Drawn by:	Paper size:	--
		--
		--
Accustraat 21 Postbus 94 3900 AB Veenendaal tel. : 0318 - 532333 fax : 0318 - 532339		--